



LANGDON HOUSE, LEATHER LANE, LONDON, EC1N

£2,600 PER CALENDAR

A well-presented sixth floor two-bedroom apartment situated in the heart of Clerkenwell on Leather Lane, EC1N. Offering approximately 635 sq ft of well-proportioned living space, the property comprises a bright open-plan kitchen/reception room, two bedrooms, and a modern bathroom.

Leather Lane is a vibrant and sought-after location known for its popular weekday food market, independent cafés, restaurants and bars. Perfectly positioned between Clerkenwell, Farringdon and Chancery Lane, the property benefits from excellent transport connections including the Elizabeth Line, Thameslink and Underground services, providing easy access across the City, West End and Canary Wharf. The area also offers a mix of historic charm and modern city living, with Exmouth Market, Hatton Garden and Smithfield all within easy reach.

Available from 23rd July 2026.



Goldman Greg

Leather Lane, EC1N 7TN

Approx Gross Internal Area = 58.95 sq m / 635 sq ft

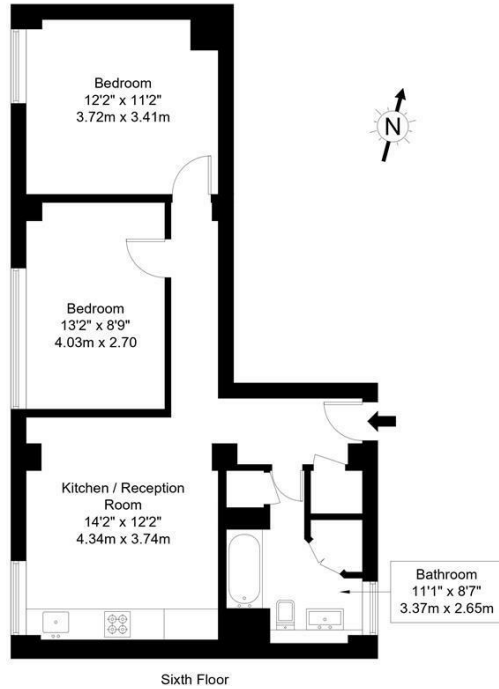

Ref :

Copyright **BLEU PLAN**

The Floor plan is not to scale and measurements and areas shown are approximate and therefore should be used for illustrative purposes only. The plan has been prepared in accordance with the RICS code of Measuring Practice and whilst we have confidence in the information produced it must not be relied on. Maximum lengths and widths are represented on the floor plan. If there is any aspect of particular importance, you should carry out or commission your own inspection of the property.
Copyright @ BLEUPLAN



Energy Efficiency Rating		
	Current	Potential
Very energy efficient - lower running costs		
(92 plus) A		
(81-91) B		
(69-80) C		
(55-68) D	61	68
(39-54) E		
(21-38) F		
(1-20) G		
Not energy efficient - higher running costs		
England & Wales	EU Directive 2002/91/EC	

Agents Note: Whilst every care has been taken to prepare these particulars, they are for guidance purposes only. All measurements are approximate and are for general guidance purposes only and whilst every care has been taken to ensure their accuracy, they should not be relied upon and potential buyers/tenants are advised to recheck the measurements

Goldman Greg
143 Leaman Street
London
E1 8EY

02079770018
leads@goldmangreg.co.uk
www.goldmangreg.co.uk

